

October 9, 2013

Mr. Nathan Magsig
Fresno County Economic Opportunities Commission
1900 Mariposa Mall, Suite 317
Fresno, CA 93721

**Subject: Sanctuary Youth Shelter
Limited Survey for Lead-Based Paint**

Dear Mr. Magsig,

Pursuant to your request, on October 4, 2013, Hazard Management Services, Inc. (HMS, Inc.) conducted a limited survey for lead-based paint (LBP) at the Sanctuary Youth Shelter located at 1545 N Street, Fresno, California. The survey was limited to interior and exterior surfaces that will be affected by the planned renovation or surfaces that may be re-painted.

The survey was performed by Harry Stevens, a CDPH certified Lead Inspector / Risk Assessor and Joe Vuglia, a CDPH certified Lead Sampling Technician. The survey was performed using a Niton X-ray fluorescence detector (XRF) and laboratory analysis of paint chip samples. The attached survey report identifies areas and building components tested with results expressed as lead content in milligrams per square centimeter.

XRF readings at or above 1.00 mg/cm² are lead-based paint as defined by the US EPA, HUD Guidelines, and California Department of Public Health. Cal/OSHA worker protection rules and lead-safe work practices are required for any work that disturbs any detectable amount of lead.

No lead-based paint was identified during this survey. Several surfaces or components surveyed by XRF show low levels of lead content; please refer to the attached survey report for specific items and readings. Laboratory analysis of a paint chip sample of the beige paint on walls and ceilings throughout the surveyed areas in the interior of the main building show that lead is not present above the limit of detection for the analysis method used - this result can be considered to be no lead detected and supercedes any contradictory XRF readings taken of the same painted surfaces.

Because low levels of lead were detected on multiple surfaces and components throughout the areas that will be renovated or re-painted, Cal/OSHA lead in construction rules will apply when any of these items are disturbed. At a minimum, any worker that disturbs any lead-containing surface or component must have "lead-safe" work practices training. While not required by regulation for this particular project, HMS, Inc. recommends that any contracting company hired for this renovation or re-painting be certified under the EPA Lead Safety for Renovation, Repair, and Painting Rule (RRP), which establishes training standards, work practices, waste handling, and clearance criteria for work which disturbs lead.

If you have any questions regarding this report, or if you desire any additional services, please contact our Fresno office at (559) 436-0277.

Sincerely,

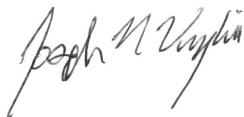

Joe Vuglia, CDPH ST 22314
Senior Project Manager

Reviewed by: Donna G. Harris, CDPH I/A 5869
President



HMS, INC.

HAZARD MANAGEMENT SERVICES, INC.

LIMITED
LEAD BASED PAINT SURVEY
By XRF

FRESNO COUNTY
ECONOMIC OPPORTUNITIES COMMISSION

SANCTUARY YOUTH SHELTER
1545 N STREET
FRESNO, CA 93721

OCTOBER 9, 2013

Survey Performed
by

HAZARD MANAGEMENT SERVICES, INC.
371 East Bullard Avenue
Fresno, CA 93710-5217
(559) 436-0277

HMS, INC.
HAZARD MANAGEMENT SERVICES, INC.

LIMITED LEAD-BASED PAINT SURVEY BY XRF

**FRESNO COUNTY
ECONOMIC OPPORTUNITIES COMMISSION**

**SANCTUARY YOUTH SHELTER
1545 N STREET
FRESNO, CA 93721**

REVIEWED BY

Harry Stevens

Harry Stevens

**DPH CERTIFIED LEAD INSPECTOR / ASSESSOR
CERT. #2399 Expiration (7-14-14)**

10-9-13
DATE

LIMITED LEAD-BASED PAINT (LBP) INSPECTION
AND SAMPLE PROTOCOL

The lead-based paint testing at this location was conducted using the following inspection and sampling protocol:

EPA/HUD/CDPH: Paint which contains at least 1.0 mg/cm², 5000 parts per million, or 0.5% by weight of lead meets the definition of "lead-based paint" as established by these agencies

OSHA & Cal/OSHA: Regulates disturbance of paint which contains any detectable amount of lead.

Cal/OSHA requires notification if over 100 sq. ft. of lead based paint (1.0 mg/cm² or higher) or presumed LBP (untested paint) is disturbed.

CONSTRUCTION YEAR

The construction dates of both buildings at this site are unknown. Paints and surface coatings that may be impacted by the planned renovations and/or repairs were sampled.

CONDITION

The condition of the paint was classified as follows:

INTACT: Paint is in good condition, with no chips, abrasions or delamination.

FAIR: Paint is reasonably intact, with minor chips and slight abrasions.

POOR: Paint is chipped, scraped, delaminated, or peeling.

EQUIPMENT AND CALIBRATION

Lead-based paint determination was performed using a Niton X-Ray Fluorescence (XRF) detector. Verification of calibration was performed prior to and immediately following testing. Inspection quality evaluation was performed according to the Performance Characteristic Sheet (PCS) for the device.

DISCLAIMER

Hazard Management Services, Inc. (HMS, Inc.) has made every effort to sample every paint type and substrate that may be disturbed by the planned work. If a painted surface that will be disturbed is not listed in this report, the paint must be assumed to contain lead, and lead-safe work practices must be used.

**LIMITED SURVEY FOR LEAD BASED PAINT
FRESNO COUNTY ECONOMIC OPPORTUNITIES COMMISSION**

Site Name:	Sanctuary Youth Shelter							Date:	10-4-13	
Address:	1545 N Street, Fresno, California							HMS Job #:	F13216	
Start Time:	09:15	Calibration:	1.04 =	0.90	1.04 =	0.90	1.04 =	0.90	Technician:	Joe Vuglia CDPH #22314
End Time:	10:45	Calibration:	1.04 =	0.90	1.04 =	1.00	1.04 =	0.90	Inspector/Assessor:	Harry Stevens CDPH #2399

Niton XLP 300 A22263 *See Lead-Based Paint Inspection, Sampling Protocol, & Definition of Lead-Based Paint on Page 1* **Condition Codes: I = Intact, F = Fair, P = Poor**

No.	Sample Location	Component	Substrate	Color	Condition	XRF Result (mg/cm2)
	CONFERENCE ROOM BUILDING - INTERIOR					
101	EAST SIDE AT CENTER	WALL	DRYWALL	WHITE	I	0.01
102	EAST SIDE AT CENTER	VENT	METAL	WHITE	I	0.00
103	EAST SIDE AT CENTER	WALL CAP	METAL	WHITE	I	0.01
104	EAST SIDE, SOUTH OF CENTER	DOOR	WOOD	TAN	F	0.00
105	EAST SIDE, SOUTH OF CENTER	DOOR FRAME	WOOD	TAN	F	0.00
106	EAST SIDE, SOUTH OF CENTER	DOOR TRIM	WOOD	TAN	I	0.00
107	CEILING AT CENTER	SUPPORT BEAM	WOOD	WHITE	I	0.01
	CONFERENCE ROOM BUILDING - EXTERIOR					
108	EAST SIDE AT CENTER	WALL	STUCCO	OFF-WHITE	I	0.01
109	SOUTH SIDE AT EAST END	WALL	WOOD	OFF-WHITE	I	0.00
110	SOUTH SIDE AT EAST END	FENCE	METAL	BLACK	I	0.01
111	EAST SIDE AT CENTER	FLASHING	METAL	BEIGE	I	0.00
	MAIN BUILDING - INTERIOR					
	RESTROOM, WOMEN					
112	WEST SIDE AT CENTER	WALL	DRYWALL	BEIGE	I	0.09

**LIMITED SURVEY FOR LEAD BASED PAINT
FRESNO COUNTY ECONOMIC OPPORTUNITIES COMMISSION**

Site Name:		Sanctuary Youth Shelter						Date:		10-4-13	
Address:		1545 N Street, Fresno, California						HMS Job #:		F13216	
Start Time:	09:15	Calibration:	1.04 =	0.90	1.04 =	0.90	1.04 =	0.90	Technician:	Joe Vuglia CDPH #22314	
End Time:	10:45	Calibration:	1.04 =	0.90	1.04 =	1.00	1.04 =	0.90	Inspector/Assessor:	Harry Stevens CDPH #2399	

Niton XLP 300 A22263 *See Lead-Based Paint Inspection, Sampling Protocol, & Definition of Lead-Based Paint on Page 1* *Condition Codes: I = Intact, F = Fair, P = Poor*

No.	Sample Location	Component	Substrate	Color	Condition	XRF Result (mg/cm ²)
	RESTROOM, WOMEN - CONTINUED					
113	WEST SIDE AT CENTER	WALL PANEL	PLASTIC	WHITE	I	0.00
114	WEST SIDE AT CENTER	PARTITION FRAME	METAL	BEIGE	I	0.04
115	WEST SIDE AT CENTER	PARTITION	METAL	BEIGE	I	0.00
116	WEST SIDE AT NORTH END	FLOOR	CERAMIC TILE	PEACH	I	0.02
117	WEST SIDE AT NORTH END	FLOOR	CERAMIC TILE	GREY	I	0.00
118	EAST SIDE AT NORTH END	DOOR FRAME	METAL	BEIGE	I	0.00
119	EAST SIDE AT NORTH END	DOOR	WOOD	VARNISH	I	0.00
120	WEST SIDE AT CENTER	TOILET	PORCELAIN	WHITE	I	0.14
121	EAST SIDE AT CENTER	SINK	PORCELAIN	WHITE	I	0.02
	STAFF RESTROOM, WOMEN					
122	WEST SIDE AT NORTH END	WALL	CERAMIC TILE	OFF-WHITE	I	0.03
123	WEST SIDE AT NORTH END	WALL	CERAMIC TILE	PEACH	I	0.02
124	WEST SIDE AT NORTH END	WALL	DRYWALL	BEIGE	I	0.00
125	WEST SIDE AT SOUTH END	DOOR FRAME	METAL	TAN	I	0.00
126	EAST SIDE AT CENTER	FLOOR	CERAMIC TILE	PEACH	I	0.00
127	EAST SIDE AT CENTER	FLOOR	CERAMIC TILE	GREY	I	0.01

**LIMITED SURVEY FOR LEAD BASED PAINT
FRESNO COUNTY ECONOMIC OPPORTUNITIES COMMISSION**

Site Name:		Sanctuary Youth Shelter						Date:		10-4-13	
Address:		1545 N Street, Fresno, California						HMS Job #:		F13216	
Start Time:	09:15	Calibration:	1.04 =	0.90	1.04 =	0.90	1.04 =	0.90	Technician:	Joe Vuglia CDPH #22314	
End Time:	10:45	Calibration:	1.04 =	0.90	1.04 =	1.00	1.04 =	0.90	Inspector/Assessor:	Harry Stevens CDPH #2399	

Niton XLP 300 A22263 *See Lead-Based Paint Inspection, Sampling Protocol, & Definition of Lead-Based Paint on Page 1* **Condition Codes: I = Intact, F = Fair, P = Poor**

No.	Sample Location	Component	Substrate	Color	Condition	XRF Result (mg/cm ²)
	STAFF RESTROOM, WOMEN - CONTINUED					
128	EAST SIDE AT NORTH END	TOILET	PORCELAIN	WHITE	I	0.19
129	EAST SIDE AT SOUTH END	SINK	PORCELAIN	WHITE	I	0.07
130	CEILING, EAST SIDE AT CENTER	VENT	METAL	TAN	I	0.00
	STAFF RESTROOM, MEN					
131	WEST SIDE AT SOUTH END	WALL	CERAMIC TILE	WHITE	I	0.00
132	WEST SIDE AT SOUTH END	WALL	CERAMIC TILE	GREEN	I	0.00
133	WEST SIDE AT SOUTH END	WALL	CERAMIC TILE	BEIGE	I	0.08
134	FLOOR AT CENTER	FLOOR	CERAMIC TILE	GREEN	I	0.01
135	FLOOR AT CENTER	FLOOR	CERAMIC TILE	TAN	I	0.01
136	WEST SIDE AT CENTER	DOOR FRAME	METAL	TAN	I	0.00
137	WEST SIDE AT CENTER	DOOR	WOOD	VARNISH	I	0.00
	RESTROOM, MEN					
138	EAST SIDE, NORTH OF CENTER	WALL	DRYWALL	BEIGE	I	0.00
139	SOUTH SIDE AT CENTER	URINAL	PORCELAIN	WHITE	I	0.02
140	NORTH SIDE AT CENTER	SINK	PORCELAIN	WHITE	I	0.03
141	WEST SIDE AT CENTER	PARTITION FRAME	METAL	TAN	I	0.00

**LIMITED SURVEY FOR LEAD BASED PAINT
FRESNO COUNTY ECONOMIC OPPORTUNITIES COMMISSION**

Site Name:		Sanctuary Youth Shelter						Date:		10-4-13	
Address:		1545 N Street, Fresno, California						HMS Job #:		F13216	
Start Time:	09:15	Calibration:	1.04 =	0.90	1.04 =	0.90	1.04 =	0.90	Technician:	Joe Vuglia CDPH #22314	
End Time:	10:45	Calibration:	1.04 =	0.90	1.04 =	1.00	1.04 =	0.90	Inspector/Assessor:	Harry Stevens CDPH #2399	

Niton XLP 300 A22263 *See Lead-Based Paint Inspection, Sampling Protocol, & Definition of Lead-Based Paint on Page 1* *Condition Codes: I = Intact, F = Fair, P = Poor*

No.	Sample Location	Component	Substrate	Color	Condition	XRF Result (mg/cm ²)
	RESTROOM, MEN - CONTINUED					
142	WEST SIDE AT CENTER	PARTITION	METAL	WHITE	I	0.01
	SHOWER ROOM, MEN					
143	NORTH SIDE AT CENTER	WALL	CERAMIC TILE	BEIGE	I	0.01
144	NORTH SIDE AT CENTER	WALL	CERAMIC TILE	MAROON	I	0.01
145	NORTH SIDE AT CENTER	WALL	CERAMIC TILE	DARK GREEN	I	0.00
146	CEILING, AT CENTER	VENT	METAL	WHITE	I	0.07
147	EAST SIDE AT NORTH END	DOOR FRAME	METAL	TAN	F	0.00
148	SOUTH SIDE AT WEST END	SINK	PORCELAIN	WHITE	I	0.01
149	SOUTH SIDE AT WEST END	COUNTER	FORMICA	TEAL	F	0.00
	SHOWER ROOM, WOMEN					
150	EAST SIDE, SOUTH OF CENTER	WALL	CERAMIC TILE	PEACH	I	0.02
151	EAST SIDE, SOUTH OF CENTER	WALL	CERAMIC TILE	OFF-WHITE	I	0.03
152	EAST SIDE, SOUTH OF CENTER	DOOR FRAME	METAL	TAN	F	0.00
153	EAST SIDE, SOUTH OF CENTER	DOOR	WOOD	VARNISH	I	0.00
154	SOUTH SIDE AT EAST END	SINK	PORCELAIN	WHITE	I	0.02

**LIMITED SURVEY FOR LEAD BASED PAINT
FRESNO COUNTY ECONOMIC OPPORTUNITIES COMMISSION**

Site Name:		Sanctuary Youth Shelter						Date:		10-4-13	
Address:		1545 N Street, Fresno, California						HMS Job #:		F13216	
Start Time:	09:15	Calibration:	1.04 =	0.90	1.04 =	0.90	1.04 =	0.90	Technician:	Joe Vuglia CDPH #22314	
End Time:	10:45	Calibration:	1.04 =	0.90	1.04 =	1.00	1.04 =	0.90	Inspector/Assessor:	Harry Stevens CDPH #2399	

Niton XLP 300 A22263 *See Lead-Based Paint Inspection, Sampling Protocol, & Definition of Lead-Based Paint on Page 1* *Condition Codes: I = Intact, F = Fair, P = Poor*

No.	Sample Location	Component	Substrate	Color	Condition	XRF Result (mg/cm ²)
	CASE MANAGEMENT OFFICE 1					
155	SOUTH SIDE AT EAST END	WINDOW SILL	WOOD	OFF-WHITE	F	0.00
156	SOUTH SIDE AT EAST END	WINDOW APRON	WOOD	OFF-WHITE	I	0.00
157	SOUTH SIDE AT EAST END	WALL	DRYWALL	OFF-WHITE	I	0.00
	MAIN BUILDING - EXTERIOR					
158	EAST SIDE AT CENTER	FLASHING	METAL	BROWN	F	0.00
159	EAST SIDE AT CENTER	TRIM	METAL	BROWN	F	0.01
160	EAST SIDE AT CENTER	WINDOW FRAME	METAL	BEIGE	I	0.00
161	EAST SIDE AT CENTER	DOOR FRAME	METAL	BEIGE	I	0.00
162	NORTH SIDE AT CENTER	WINDOW TRIM	WOOD	BROWN	I	0.00
163	NORTH SIDE AT WEST END	WINDOW BARS	METAL	BLACK	F	0.00
164	WEST SIDE AT CENTER	DOOR (INTERIOR)	METAL	OFF-WHITE	F	0.02
165	WEST SIDE AT CENTER	DOOR (EXTERIOR)	METAL	BROWN	F	0.01
166	WEST SIDE AT CENTER	DOOR FRAME	METAL	BROWN	F	0.03
167	WEST SIDE AT CENTER	DOWN SPOUT	METAL	BROWN	F	0.03
168	WEST SIDE AT CENTER	SCUPPER	METAL	BROWN	F	0.00
169	WEST SIDE AT CENTER	VENT	METAL	BROWN	F	0.00



Metals Analysis of Paints

Hazard Mgmt Svcs-Fresno/Bakersfield
Debby Brady
Fresno Location
371 E. Bullard Ave., Ste. 109
Fresno, CA 93710

Client ID: 1636
Report Number: M143530
Date Received: 10/07/13
Date Analyzed: 10/08/13
Date Printed: 10/08/13
First Reported: 10/08/13

Job ID / Site: F13216, Fresno EOC, Sanctuary Youth Shelter
Date(s) Collected: 10/04/13

FALI Job ID: 1636
Total Samples Submitted: 1
Total Samples Analyzed: 1

Sample Number	Lab Number	Analyte	Result	Result Units	Reporting Limit*	Method Reference
HMS-FEOC-SYS-F13216-01	30661188	Pb	< 0.006	wt%	0.006	EPA 3050B/7420

* The Reporting Limit represents the lowest amount of analyte that the laboratory can confidently detect in the sample, and is not a regulatory level. The Units for the Reporting Limit are the same as the Units for the Final Results.

Daniele Siu, Laboratory Supervisor, Hayward Laboratory

Analytical results and reports are generated by Forensic Analytical at the request of and for the exclusive use of the person or entity (client) named on such report. Results, reports or copies of same will not be released by Forensic Analytical to any third party without prior written request from client. This report applies only to the sample(s) tested. Supporting laboratory documentation is available upon request. This report must not be reproduced except in full, unless approved by Forensic Analytical. The client is solely responsible for the use and interpretation of test results and reports requested from Forensic Analytical. Forensic Analytical is not able to assess the degree of hazard resulting from materials analyzed. Forensic Analytical reserves the right to dispose of all samples after a period of thirty (30) days, according to all state and federal guidelines, unless otherwise specified. Any modifications that have been made to referenced test methods are documented in Forensic Analytical's Standard Operating Procedures Manual. Sample results have not been blank corrected. Quality control and sample receipt condition were acceptable unless otherwise noted.

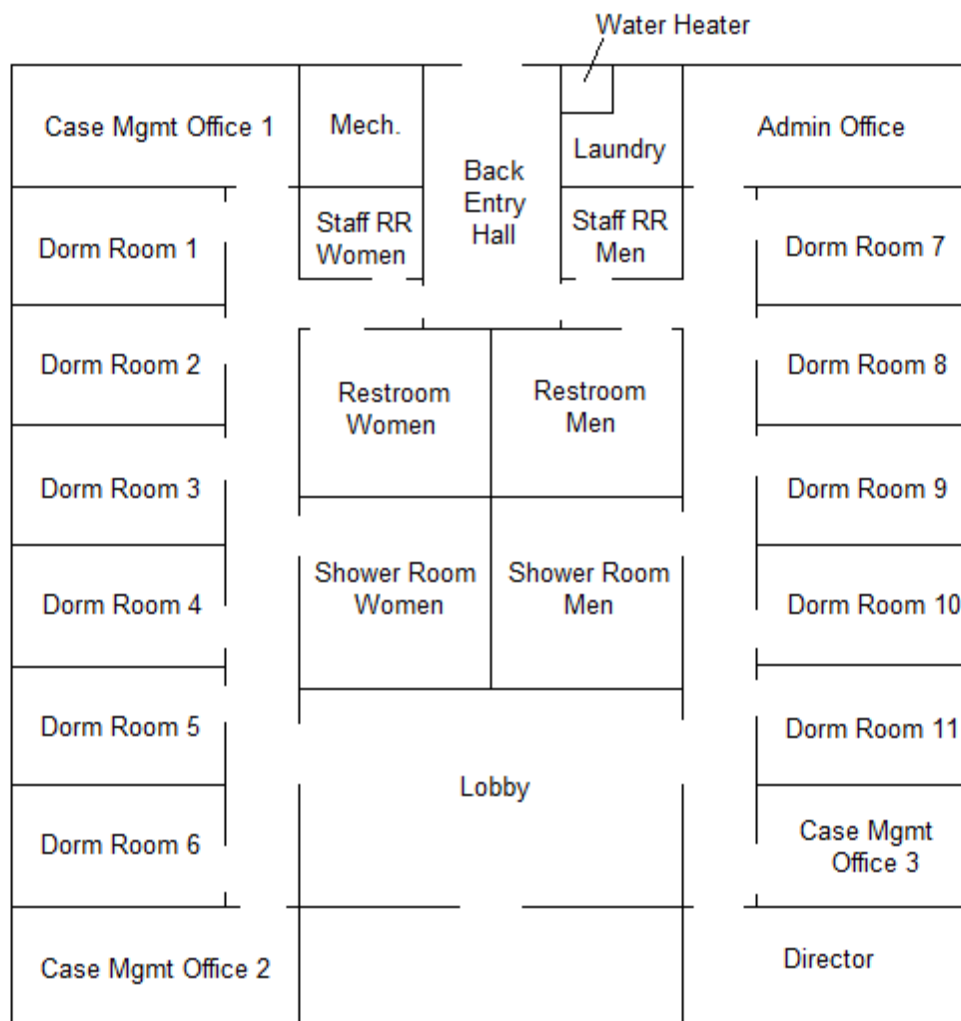

1545 N Street, Fresno, CA

1/4" = 4'
Drawing is not to
exact scale

